

Operating Instructions Portable CD Player

SL-SW945



Dear Customer

Thank you for purchasing this product. Before connecting, operating or adjusting this product, please read these instructions completely. Please keep this manual for future reference.

COMPACT
disc
DIGITAL AUDIO

P PC En

Panasonic Consumer Electronics Company,
Division of Matsushita Electric Corporation of America
One Panasonic Way Secaucus, New Jersey 07094 <http://www.panasonic.com>

RQT7549-P
F0104TR1024

HOLD
This function causes the unit to ignore accidental button presses. Set to HOLD so the unit doesn't power on accidentally or interrupt play.
•The unit and remote control each have independent HOLD switches.

Note on CD-R and CD-RW
This unit can play CD-DA format audio CD-R and CD-RW that have been finalized* upon completion of recording. It may not be able to play some CD-R or CD-RW due to the condition of the recording.
※Finalizing is a process that enables CD-R/CD-RW players to play audio CD-R and CD-RW.

Resume function
The player stores the track where you stopped play. Opening the lid when the unit is in stop mode cancels the function.

Auto off function
If the unit is left in stop mode for approximately 10 minutes, the unit turns itself off automatically.

Supplied Accessories

Check the packing carton for these accessories.

- 1 Pair of stereo headphones:
LOBAD0000169
- 1 Wired remote control:
N2QCBD000042
- 1 Hand strap:
RGQT0006-K1

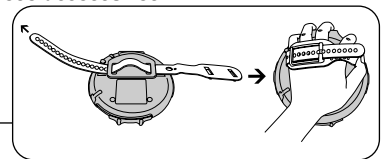

Use numbers indicated when ordering replacements or optional accessories from your Panasonic dealer.
In the U.S.A. to order accessories, refer to "Accessory Purchases" on page 2.

The model number and serial number of this product can be found on either the back or the bottom of the unit.

Please note them in the space provided below and keep for future reference.

MODEL NUMBER SL-SW945
SERIAL NUMBER _____

Panasonic Sales Company,
Division of Matsushita Electric of Puerto Rico, Inc. ("PSC")
Ave. 65 de Infantería, Km. 9.5 San Gabriel Industrial Park, Carolina, Puerto Rico 00985

Panasonic Canada Inc.
5770 Ambler Drive, Mississauga, Ontario L4W 2T3 www.panasonic.ca

© 2004 Matsushita Electric Industrial Co., Ltd.
Printed in Japan

Troubleshooting guide

Before requesting service, make the following checks. If you are in doubt about some of the check points, or if the remedies indicated in the chart do not solve the problem, refer to the "Customer Services Directory" on page 2 if you reside in the U.S.A., or refer to the "Product information" on page 2 if you reside in Canada.

No play.	<ul style="list-style-type: none"> •The HOLD function is on. Release HOLD (⇄page 4). •The batteries may have run empty (⇄page 3). (If play is extremely short even after fully recharging the batteries, the batteries may have exceeded their life. Rechargeable batteries can be recharged approximately 300 times.) •The disc isn't correctly set. •The disc is scratched or dirty. (Tracks skipped.) •There is moisture on the lens. Wait for about an hour and then try again. •The lens is dirty: clean it with a blower (recommended product: SZZP1038C). If the lens gets marked with fingerprints, gently wipe them off with a cotton swab.
No sound or there is a lot of noise.	<ul style="list-style-type: none"> •Ensure the plugs are inserted firmly. •Wipe the plugs clean with a clean cloth. •The elapsed playing time disappears and sound is interrupted if bumps continue repeatedly. •Separate this unit from mobile telephones.
Play doesn't resume from the track where play stopped at.	<ul style="list-style-type: none"> •This doesn't work if you open the lid while the unit is in stop mode. •This doesn't work during random play. •It may not work correctly under some conditions.
Play doesn't start from the first track.	<ul style="list-style-type: none"> •Random play modes may be on (⇄page 4). •Play resumes from the track where you last stopped play (play may start from a different track if you change discs after the power has been turned off).
The unit stops working.	Disconnect then reconnect all power sources (batteries and AC adaptor).
Cannot change the Anti-skip mode.	If [◀◀] or [▶▶] is pressed before [MEMORY/RECALL] you cannot change the mode.
Cannot specify point A or B.	You may not be able to specify point A or B at the end of disc.
The unit malfunctions when connected to other equipment.	Be sure to connect other equipment through the remote control. Speakers connected directly to the unit should have an impedance of 1 kΩ or less.
Cannot hear the remote control's operation tone.	The operation tone may be off (⇄page 4).
The remote control does not work properly.	Use only the included remote control to operate this unit.
Cannot recharge.	<ul style="list-style-type: none"> •You aren't using the special rechargeable batteries (⇄page 3). •You must insert two batteries before you can recharge them. •The unit must be off before you can recharge.
The AC adaptor becomes warm during recharging.	This is normal.
The batteries are taking a long time to recharge.	The batteries may take a maximum of 6 hours to recharge under some conditions.

Play time is short after recharging.	<ul style="list-style-type: none"> •This may occur after the first time you recharge the batteries or haven't used them for a long time. Play time should be restored after a few recharges. •The batteries can go flat if you leave the AC adaptor connected after recharging is complete.
The battery indicator fails to appear or is incorrect.	<ul style="list-style-type: none"> •The indicator does not appear when an AC adaptor is connected. •The indicator does not appear correctly under some conditions.

Display	
hold	The HOLD function is on. Release HOLD (⇄page 4).
no disc	<ul style="list-style-type: none"> •You haven't inserted a disc or it isn't inserted correctly. •You have inserted a disc this unit cannot play.
OPEN	The disc lid is open.
F	The program already contains 20 tracks.

Specifications	
Audio	
Sampling frequency:	44.1 kHz
No. of channels:	2 (left and right, stereo)
Headphone output level:	RMS max. 6 mW + 6 mW / 16 Ω (adjustable)
Frequency response:	20 Hz to 20,000 Hz (+0 dB to -7 dB)
Pickup	
Light source:	Semiconductor laser
Wavelength:	780 nm
General	
Power supply:	DC input (AC adaptor, not included): DC 4.5 V
Operational temperature range:	0 °C-40 °C (32 °F-104 °F)
Rechargeable temperature range:	5 °C-40 °C (41 °F-104 °F)
Play time:	Using on a flat stable surface at 25 °C (77 °F), EQ is off, Hold is on, Anti-skip is on POS 1. Play times are in hours and approximate.
Batteries used	Play time
2 optional alkaline batteries	50
2 optional rechargeable batteries	25
Recharging time:	About 4 to 5 hours
<ul style="list-style-type: none"> •The play time may be less depending on the operating conditions. •Play time will be considerably reduced when playing CD-RW. 	
Dimensions (W×H×D):	142×29.7×142 mm (5 5/16"×1 13/16"×5 5/16")
Mass:	321 g (11.3 oz.) (with batteries) 275 g (9.7 oz.) (without batteries)
Note:	Specifications are subject to change without notice. Mass and dimensions are approximate.

IMPORTANT SAFETY INSTRUCTIONS

Read these operating instructions carefully before using the unit. Follow the safety instructions on the unit and the applicable safety instructions listed below. Keep these operating instructions handy for future reference.

- 1) Read these instructions.
 - 2) Keep these instructions.
 - 3) Heed all warnings.
 - 4) Follow all instructions.
 - 5) Do not use this apparatus near water.
 - 6) Clean only with dry cloth.
 - 7) Do not block any ventilation openings. Install in accordance with the manufacturer's instructions.
 - 8) Do not install near any heat sources such as radiators, heat registers, stoves, or other apparatus (including amplifiers) that produce heat.
 - 9) Do not defeat the safety purpose of the polarized or grounding-type plug. A polarized plug has two blades with one wider than the other. A grounding-type plug has two blades and a third grounding prong. The wide blade or the third prong are provided for your safety. If the provided plug does not fit into your outlet, consult an electrician for replacement of the obsolete outlet.
 - 10) Protect the power cord from being walked on or pinched particularly at plugs, convenience receptacles, and the point where they exit from the apparatus.
 - 11) Only use attachments/accessories specified by the manufacturer.
 - 12) Use only with the cart, stand, tripod, bracket, or table specified by the manufacturer, or sold with the apparatus. When a cart is used, use caution when moving the cart/apparatus combination to avoid injury from tip-over.
- 
- 13) Unplug this apparatus during lightning storms or when unused for long periods of time.
 - 14) Refer all servicing to qualified service personnel. Servicing is required when the apparatus has been damaged in any way, such as power-supply cord or plug is damaged, liquid has been spilled or objects have fallen into the apparatus, the apparatus has been exposed to rain or moisture, does not operate normally, or has been dropped.

WARNING:
TO REDUCE THE RISK OF FIRE, ELECTRIC SHOCK OR PRODUCT DAMAGE, DO NOT EXPOSE THIS APPARATUS TO RAIN, MOISTURE, DRIPPING OR SPLASHING AND THAT NO OBJECTS FILLED WITH LIQUIDS, SUCH AS VASES, SHALL BE PLACED ON THE APPARATUS.

CAUTION!
THIS PRODUCT UTILIZES A LASER.
USE OF CONTROLS OR ADJUSTMENTS OR PERFORMANCE OF PROCEDURES OTHER THAN THOSE SPECIFIED HEREIN MAY RESULT IN HAZARDOUS RADIATION EXPOSURE.
DO NOT OPEN COVERS AND DO NOT REPAIR YOURSELF. REFER SERVICING TO QUALIFIED PERSONNEL.

CAUTION:
Use only car adaptor, Model: SH-CDC9
manufactured by Matsushita Electric Industrial Co., Ltd.

Marking sign is located on bottom of the unit.

Product service

1. **Damage requiring service**—The unit should be serviced by qualified service personnel if:
 - (a) The AC power supply cord or AC adaptor has been damaged; or
 - (b) Objects or liquids have gotten into the unit; or
 - (c) The unit has been exposed to rain; or
 - (d) The unit does not operate normally or exhibits a marked change in performance; or
 - (e) The unit has been dropped or the cabinet damaged.
2. **Servicing**—Do not attempt to service the unit beyond that described in these operating instructions. Refer all other servicing to authorized servicing personnel.
3. **Replacement parts**—When parts need replacing ensure the servicer uses parts specified by the manufacturer or parts that have the same characteristics as the original parts. Unauthorized substitutes may result in fire, electric shock, or other hazards.
4. **Safety check**—After repairs or service, ask the servicer to perform safety checks to confirm that the unit is in proper working condition.

Product information

For product information or assistance with product operation:
In the U.S.A., refer to "Customer Services Directory" below.

For assistance in the continental U.S.A. in obtaining repairs please ship the product to:

Panasonic Services Company - Customer Servicer
Suite B 4900 George McVay Drive
McAllen, TX 78503

In Puerto Rico contact the Panasonic Sales Company.

Tel. (787) 750-4300 Fax. (787) 768-2910

When shipping the unit carefully pack and send it prepaid, adequately insured and preferably in the original carton. Include a letter detailing the complaint and provide a day time phone number where you can be reached.

IF REPAIR IS NEEDED DURING THE WARRANTY PERIOD THE PURCHASER WILL BE REQUIRED TO FURNISH A SALES RECEIPT/PROOF OF PURCHASE INDICATING DATE OF PURCHASE, AMOUNT PAID AND PLACE OF PURCHASE. CUSTOMER WILL BE CHARGED FOR THE REPAIR OF ANY UNIT RECEIVED WITHOUT SUCH PROOF OF PURCHASE.

Also, the purchaser will be responsible for shipping the unit to the above address.

In Canada, contact the Panasonic Canada Inc. Customer Care Centre at 905-624-5505, or visit the website (www.panasonic.ca), or an authorized Servicer closest to you.

THE FOLLOWING APPLIES ONLY IN THE U.S.A.

CAUTION:

This equipment has been tested and found to comply with the limits for a Class B digital device, pursuant to Part 15 of the FCC Rules.

These limits are designed to provide reasonable protection against harmful interference in a residential installation. This equipment generates, uses and can radiate radio frequency energy and, if not installed and used in accordance with the instructions, may cause harmful interference to radio communications. However, there is no guarantee that interference will not occur in a particular installation. If this equipment does cause harmful interference to radio or television reception, which can be determined by turning the equipment off and on, the user is encouraged to try to correct the interference by one or more of the following measures:

- Reorient or relocate the receiving antenna.
 - Increase the separation between the equipment and receiver.
 - Connect the equipment into an outlet on a circuit different from that to which the receiver is connected.
 - Consult the dealer or an experienced radio/TV technician for help.
- Any unauthorized changes or modifications to this equipment would void the user's authority to operate this device.

This device complies with Part 15 of the FCC Rules. Operation is subject to the following two conditions: (1) This device may not cause harmful interference, and (2) this device must accept any interference received, including interference that may cause undesired operation.

Panasonic Consumer Electronics Company,
Division of Matsushita Electric Corporation of America
One Panasonic Way Secaucus, New Jersey 07094

ONLY FOR U.S.A.

Panasonic Sales Company, Division of Matsushita Electric
of Puerto Rico, Inc.,
Ave. 65 de Infanteria, Km. 9.5
San Gabriel Industrial Park, Carolina, Puerto Rico 00985

Panasonic Portable Audio Products Limited Warranty

Limited Warranty Coverage

If your product does not work properly because of a defect in materials or workmanship, Panasonic Consumer Electronics Company or Panasonic Sales Company (collectively referred to as "the warrantor") will, for the length of the period indicated on the chart below, which starts with the date of original purchase ("warranty period"), at its option either (a) repair your product with new or refurbished parts, or (b) replace it with a new or a refurbished product. The decision to repair or replace will be made by the warrantor.

Product or Part Name	Parts	Labor
All Portable Audio Products except item listed below	One (1) Year	One (1) Year
Rechargeable batteries (in exchange for defective item)	Ten (10) Days	Not applicable

During the "Labor" warranty period there will be no charge for labor. During the "Parts" warranty period, there will be no charge for parts. You must mail-in your product during the warranty period. This Limited Warranty excludes both parts and labor for batteries, antennas, and cosmetic parts (cabinet). This warranty only applies to products purchased and serviced in the United States or Puerto Rico. This warranty is extended only to the original purchaser of a new product which was not sold "as is".

Mail-In Service

For assistance in the continental U.S.A. in obtaining repairs please ship the product to:

Panasonic Services Company
Customer Servicer
Suite B
4900 George McVay Drive
McAllen, TX 78503

For assistance in Puerto Rico call Panasonic Sales Company (787)-750-4300 or fax (787)-768-2910. When shipping the unit carefully pack and send it prepaid, adequately insured and preferably in the original carton. Include a letter detailing the complaint and provide a day time phone number where you can be reached.

Customer Services Directory

Obtain Product Information and Operating Assistance; locate your nearest Dealer or Servicer; purchase Parts and Accessories; or make Customer Service and Literature requests by visiting our Web Site at:

<http://www.panasonic.com/support>

or, contact us via the web at:

<http://www.panasonic.com/contactinfo>

You may also contact us directly at:

1-800-211-PANA (7262),

Monday-Friday 9 am-9 pm; Saturday-Sunday 10 am-7 pm, EST.

For hearing or speech impaired TTY users, TTY : 1-877-833-8855

IF REPAIR IS NEEDED DURING THE WARRANTY PERIOD THE PURCHASER WILL BE REQUIRED TO FURNISH A SALES RECEIPT/PROOF OF PURCHASE INDICATING DATE OF PURCHASE, AMOUNT PAID AND PLACE OF PURCHASE. CUSTOMER WILL BE CHARGED FOR THE REPAIR OF ANY UNIT RECEIVED WITHOUT SUCH PROOF OF PURCHASE.

Limited Warranty Limits And Exclusions

This warranty ONLY COVERS failures due to defects in materials or workmanship, and DOES NOT COVER normal wear and tear or cosmetic damage. The warranty ALSO DOES NOT COVER damages which occurred in shipment, or failures which are caused by products not supplied by the warrantor, or failures which result from accidents, misuse, abuse, neglect, mishandling, misapplication, alteration, faulty installation, set-up adjustments, misadjustment of consumer controls, improper maintenance, power line surge, lightning damage, modification, introduction of sand, humidity or liquids, commercial use such as hotel, office, restaurant, or other business or rental use of the product, or service by anyone other than a Factory Servicer or other Authorized Servicer, or damage that is attributable to acts of God.

THERE ARE NO EXPRESS WARRANTIES EXCEPT AS LISTED UNDER "LIMITED WARRANTY COVERAGE". THE WARRANTOR IS NOT LIABLE FOR INCIDENTAL OR CONSEQUENTIAL DAMAGES RESULTING FROM THE USE OF THIS PRODUCT, OR ARISING OUT OF ANY BREACH OF THIS WARRANTY. (As examples, this excludes damages for lost time, travel to and from the servicer, loss of or damage to media or images, data or other memory or recorded content. The items listed are not exclusive, but are for illustration only.)

ALL EXPRESS AND IMPLIED WARRANTIES, INCLUDING THE WARRANTY OF MERCHANTABILITY, ARE LIMITED TO THE PERIOD OF THE LIMITED WARRANTY.

Some states do not allow the exclusion or limitation of incidental or consequential damages, or limitations on how long an implied warranty lasts, so the exclusions may not apply to you. This warranty gives you specific legal rights and you may also have other rights which vary from state to state. If a problem with this product develops during or after the warranty period, you may contact your dealer or Servicer. If the problem is not handled to your satisfaction, then write to the warrantor's Consumer Affairs Department at the addresses listed for the warrantor. **PARTS AND SERVICE, WHICH ARE NOT COVERED BY THIS LIMITED WARRANTY, ARE YOUR RESPONSIBILITY.**

Accessory Purchases

Purchase Parts, Accessories and Instruction Books online for all Panasonic Products by visiting our Web Site at: <http://www.pasc.panasonic.com>

or, send your request by E-mail to: npcparts@panasonic.com

You may also contact us directly at:

1-800-332-5368 (Phone) 1-800-237-9080 (Fax Only) (Monday - Friday 9 am to 8 pm, EST.)

Panasonic Services Company
20421 84th Avenue South, Kent, WA 98032

(We Accept Visa, MasterCard, Discover Card, American Express, and Personal Checks)

For hearing or speech impaired TTY users, TTY : 1-866-605-1277

Service in Puerto Rico

Matsushita Electric of Puerto Rico, Inc. Panasonic Sales Company/Factory Servicer:
Ave. 65 de Infanteria, Km. 9.5, San Gabriel Industrial Park, Carolina, Puerto Rico 00985
Phone (787)750-4300, Fax (787)768-2910

Location of controls/Connection to other equipment

Main unit

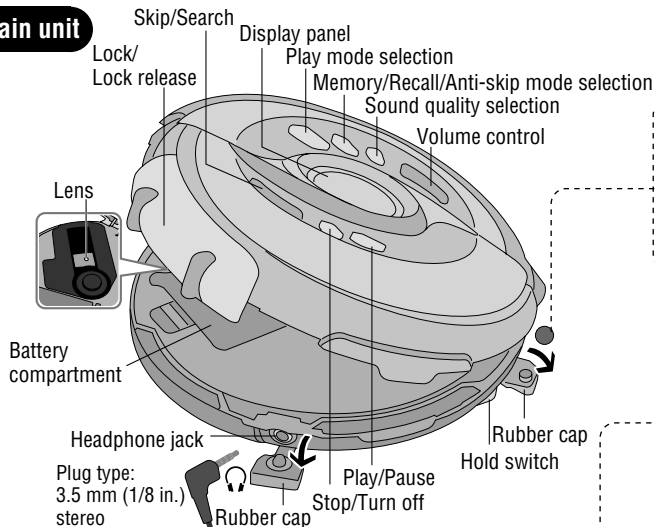

- Turn off this unit and the other equipment before connection.
- If you don't want the remote control sound, turn it off. (↔ page 4)

To DC IN jack

AC adaptor (RP-AC46) (not included)
Connect the AC adaptor to the household AC outlet first.



- Car power adaptor (SH-CDC9)** (not included)
- When you switch off the car, the volume returns to 10.
 - You can recharge the batteries with this connection.



Car audio



Some cannot be connected.

To remote control jack

Connect the remote control to main unit first.

Car stereo cassette adaptor (SH-CDM10A) (not included)

Set the unit's volume to 10-15.



To CD or AUX terminals

Audio cable (not included)

Set the unit's volume to 10-15.

Audio system

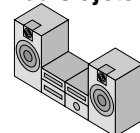

Adjust the volume level on the audio system.

Remote control

Using headphones

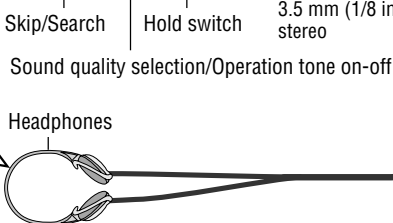

Caution

Water Resistant (Splash Proof)

The main unit, headphones and remote control are splash proof, however damage may result if water gets inside them.

- Do not use in water or splash with salt water or a lot of water.
- Wipe off water, dust or sand from the unit before opening and closing the lid.
- Slide the lock firmly to close the lid.
- Insert the rubber caps into the headphone and DC IN jacks when not using the unit.

Batteries

- Do not peel off the covering on batteries and do not use if the covering has been peeled off.
- Align the poles + and - correctly when inserting the batteries.
- Do not mix different types of batteries or old and new batteries.
- Remove the batteries if you do not intend to use the unit for a long time.
- Do not throw into a fire, short-circuit, disassemble, or subject to excessive heat.
- Do not attempt to recharge dry cell batteries.
- When carrying batteries in a pocket or bag, ensure no metal objects such as necklaces are placed together with them. Contact with metal may cause short-circuiting which can cause a fire.

CDs

- Do not use irregularly shaped CDs.
- Do not use non-specification discs.
- Do not use CDs printed with label printers available on the market.
- Do not use CDs with labels and stickers that are coming off or with adhesive exuding from under labels and stickers.

Listening



Do not play your headphones or earphones at a high volume. Hearing experts advise against continuous extended play. If you experience a ringing in your ears, reduce volume or discontinue use. Do not use while operating a motorized vehicle. It may create a traffic hazard and is illegal in many areas. You should use extreme caution or temporarily discontinue use in potentially hazardous situations. Even if your headphones or earphones are the open-air type designed to let you hear outside sounds, don't turn up the volume so high that you can't hear what's around you. Sound can be deceiving. Over time your hearing "comfort level" adapts to higher volumes of sound. So what sounds "normal" can actually be loud and harmful to your hearing. Guard against this by setting your equipment at a safe level BEFORE your hearing adapts. To establish a safe level:

- Start your volume control at a low setting.
- Slowly increase the sound until you can hear it comfortably and clearly, and without distortion. Once you have established a comfortable sound level:
- Leave it there.

Allergies

Discontinue use if you experience discomfort with the earphones or any other parts that directly contact your skin. Continued use may cause rashes or other allergic reactions.

User memo:

DATE OF PURCHASE _____
 DEALER NAME _____
 DEALER ADDRESS _____
 TELEPHONE NUMBER _____

Power Supply

Play time ↔ Specifications (page 1)

Rechargeable batteries (not included) Recharge before initial use.

Opening and closing the lid ↔ page 4

Make sure the unit is off when recharging.

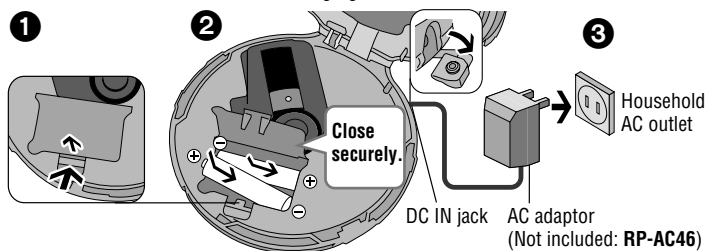

- The battery indicator () scrolls while recharging and disappears when finished (about 4 to 5 hours).
- You can recharge the batteries before they are fully discharged.
- Fit the battery lid so it is secure and flush with the battery compartment. If it comes loose, it may scratch your discs.
- To remove the batteries, lift from the left.

Optional rechargeable batteries

For details, check with your dealer.

Special rechargeable Ni-Cd batteries:
P-3GAVA/2B (set of 2)

Ordinary dry cell batteries/
rechargeable batteries



Dry cell batteries (not included)

After disconnecting the AC adaptor, insert two "LR6, AA, UM-3" alkaline batteries. Insert the same way as the rechargeable batteries.

The battery indicator

This indicator appears when the unit is on.

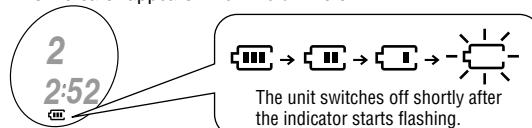

The unit switches off shortly after the indicator starts flashing.

3

- Before playing starts the battery indicator may flash although the batteries are not drained. It appears correctly once you start play.

How to Use

Playback

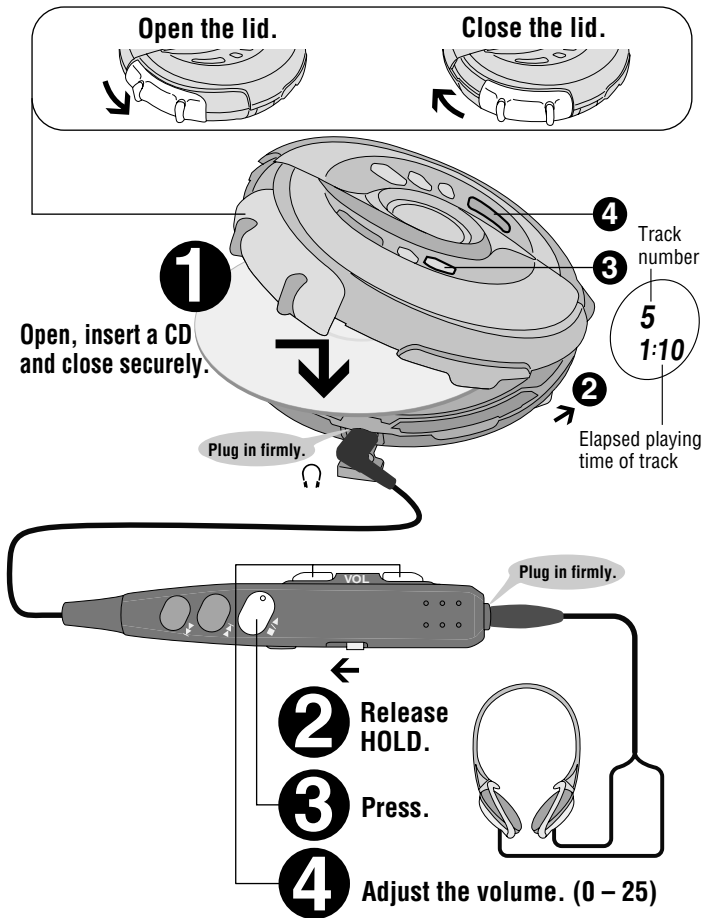

• The volume returns to 10 when you disconnect the power source.

Pause

Remote control	Main unit
Not available.	Press. ■ Press again to restart play.

Search

Remote control	Main unit
Press and hold during play.	Press and hold during play.

• You can search only within the current track during program, one track repeat, random, random repeat and AB repeat play modes (⇄ below).

Skip

Remote control	Main unit
Press.	Press.

• Press [⏮] twice to skip to the beginning of the previous track during play.
• You cannot use [⏮] to skip to the previous track during random play (⇄ below).

Stop/Turn off

Remote control	Main unit
Press. ■ Press and hold to turn the unit off.	Press. ■ Press again to turn the unit off.

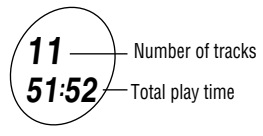

Other Play Methods

Program Play

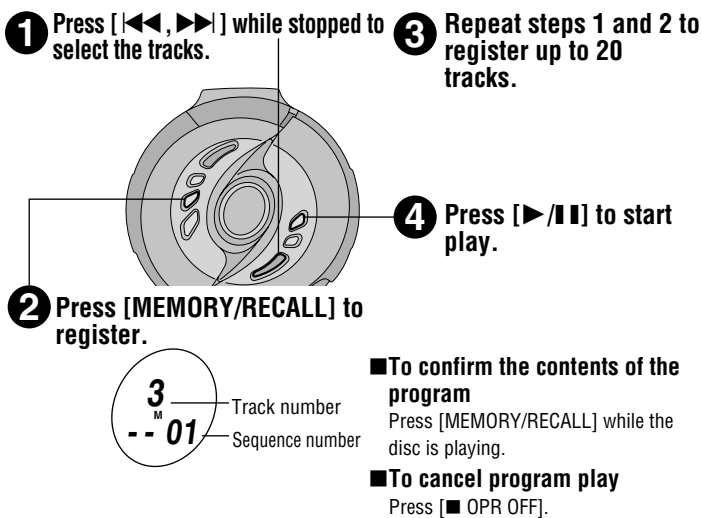

Play modes

Each time you press [MODE]

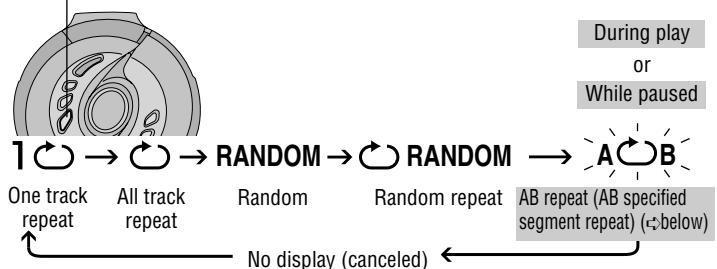

■ Specifying the AB segment
Press [MEMORY/RECALL] at the start point (A) and once more at the end point (B).
A → B → A → B

• Stop or skip (⇄ above) to cancel.
• If you do not specify point B and reach the end of disc, point B is set automatically and repeat begins. You can also specify point B again by pressing [MEMORY/RECALL].

Anti-Skip System

This system reduces the skipping caused by vibration to a minimum. You can change the anti-skip memory time to improve sound quality. While stopped, each time you press and hold [MEMORY/RECALL]

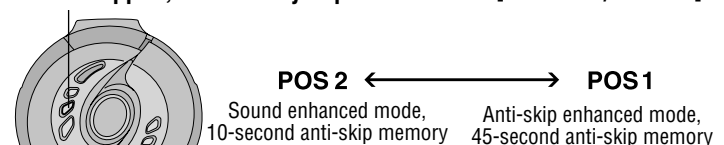

Turning the operation tone off

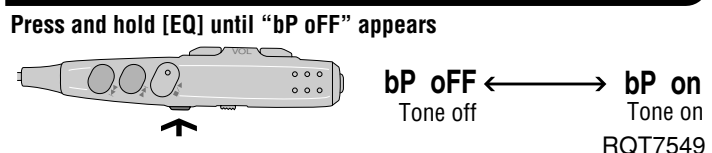

Changing the sound quality

Each time you press [EQ]

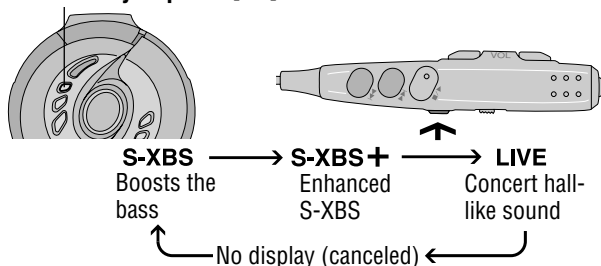

• The effect may differ between different kinds of music.